



# Instructions For Standard Model KilnShield® Assembly

*Congratulations!* You have purchased an accessory for your kiln that will prevent deterioration and greatly increase its life, while putting less strain on your back when loading! We encourage you to read the full directions before you start assembling the KilnShield®, and pay close attention to the “notes” and “tips” we provide.

**Included in this kit:** 1 metal base, 1 silicone foam pad with adhesive backing, 3 metal “L” tabs, 3 VHB tape adhesive strips, 3 silicone booties, and 2 magnets (if ordered).

The smooth hard surface of the metal base provides a smooth hard surface to protect the bricks from damage, while the silicone foam pad provides a cushion to lean on. The 3 “L” metal tabs prevent the KilnShield® from moving during usage.

## 1. Attaching VHB adhesive strip (red) to the tabs

**Note:** You will need to adhere the tape to the metal tab 2hrs before assembling the KilnShield®.

Place the “L” tab on a flat surface as shown in the photo with the short side facing up.

**Note:** VHB tape is narrower and shorter than the tab.

Place the VHB tape on the tab as shown with a little bit of metal showing on the short side between the edge of the VHB tape and the edge of the “L” tab (this will allow for the plastic covering of the VHB tape to be removed easier later). After the VHB tape has stuck to the tab, press down on it to assure a good adhesive seal. Put this aside for **2 hours** and repeat for the other tabs.

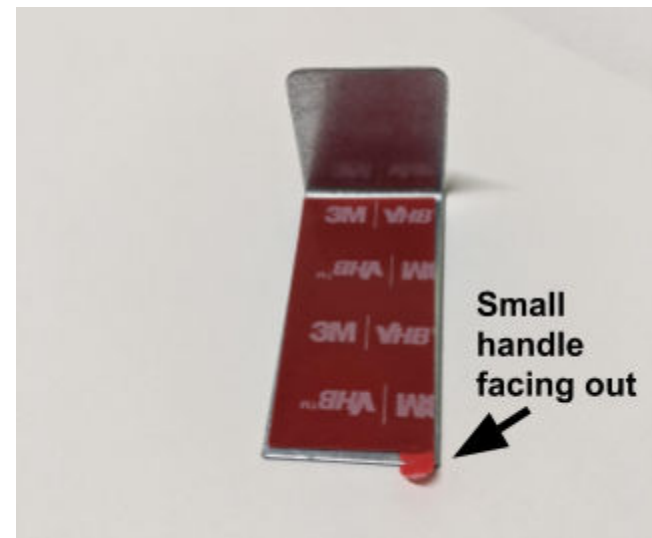
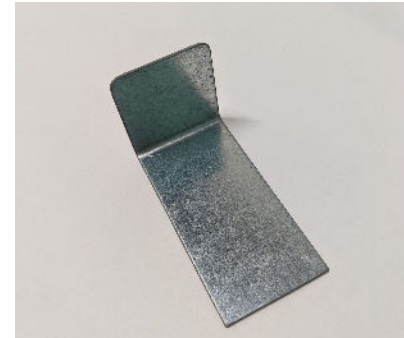

## 2. Select placement of “L” tabs

With the kiln cool, place the metal base of the KilnShield® on the three bricks to be protected. Line up the short raised edges of the metal base with the edges of the bricks (see photo). Aligned the two long sides of the metal base with the bricks inside and outside edges. Place the 3 “L” tabs (with red covering on) on the metal base in the center of the brick being protected. Ideally the three tabs will be in the middle of the bricks. Mark their location (if there is something in the way of an “L” tab, move it over to clear it by an inch or so). Do not attach the “L” tabs yet.

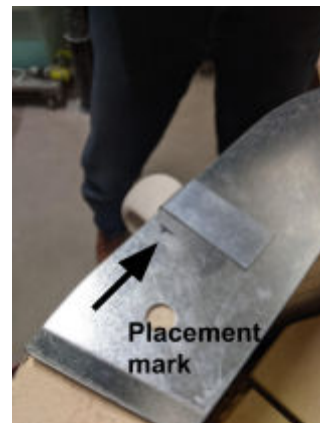

### 3. Secure “L” tabs to the Metal Base (a)

After you have marked where the tabs will go, move the metal base slightly off the brick by a 1/2” towards the outside of the kiln. Remove the red plastic covering from the VHB tape on the tab (after 1 to 2 hours of letting it set). Pulling the small handle back and up, remove the red plastic covering on the VHB tape completely. (The corner edge of the VHB tape may want to stay on the red plastic covering, keep it in place with your fingernail or straight edge like a screwdriver.

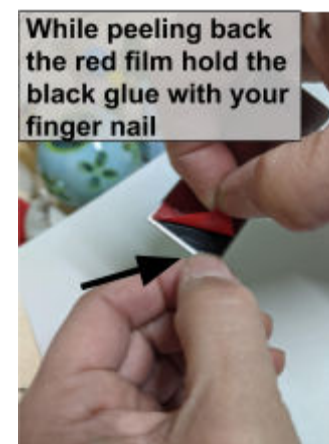
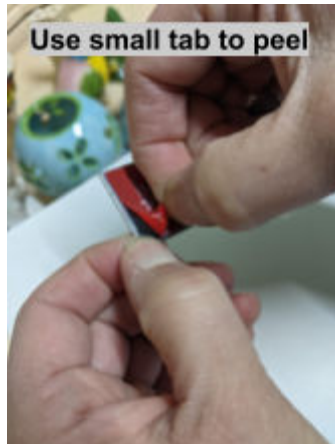

#### 4. Secure “L” tabs to the Metal Base (b)

With the metal base still extended  $\frac{1}{2}$ " beyond the exterior edge of the kiln, press the internal bent edge of the “L” tab flat against the edge of the metal base where you want to put it. Push the long side of the “L” tab (with the VHB tape) down onto the base (like a hinge) making sure the internal bent edge of the “L” tab is tight against the edge base. This is important to align the KilnShield® to the brick. Press down on the tab to ensure a good adhesive seal. The “L” tab will bond to the metal base with 50% adhesion in 20 minutes, 90% in 24hrs, and 100% in 72hrs. Be mindful in the first 24hrs.

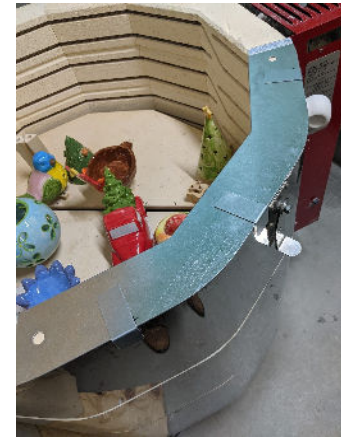

## 5. Attaching silicone pad

With the 3 “L” tabs secured, slide the metal base back on the brick so it is completely on the bricks. Place the silicone pad with the adhesive covering down and check the alignment of the silicone pad to the metal base (long sides and two holes, there may be  $\frac{1}{8}$ ” of the metal base exposed on both sides). Peel back the adhesive film on the back of the silicone pad a bit at a time, and place the pad on the base. You can move and unpeel the foam from the metal base to make an accurate fit. Press down on the foam when you are finished. Put on the 3 silicone booties and the KilnShield® is now complete.

